

Please recycle the components after the end of their service life to appropriately certified disposal companies!

**CAUTION!** This is not a toy.

Not suitable for children under 14 years.

For young people and children under 14 years, assembly must be supervised and accompanied by a competent adult.

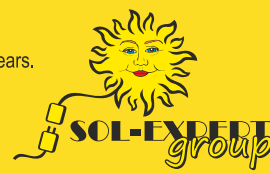

No. 40214

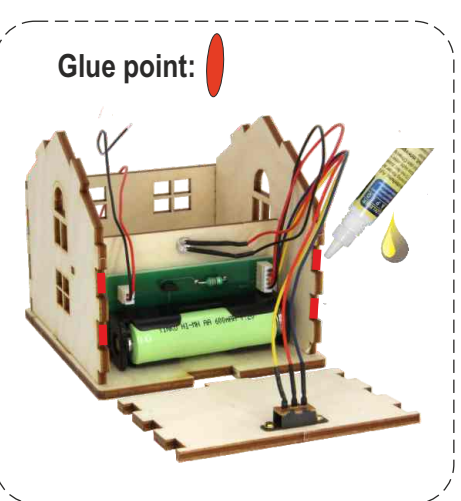
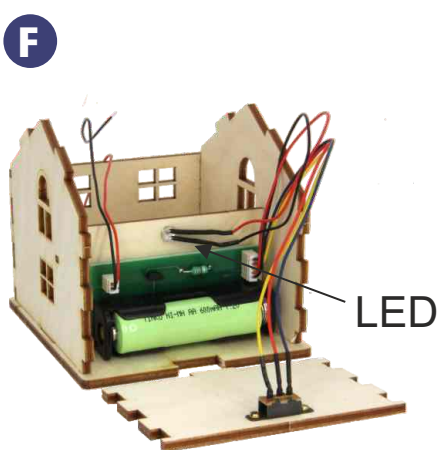
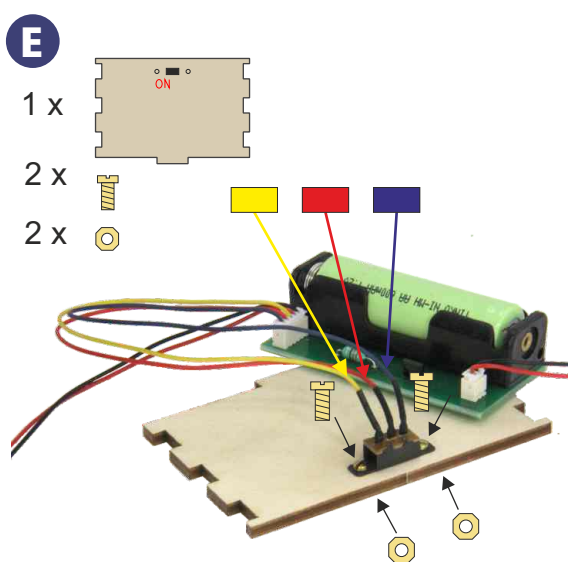
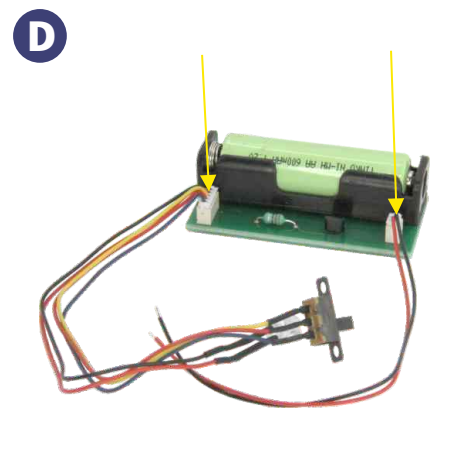
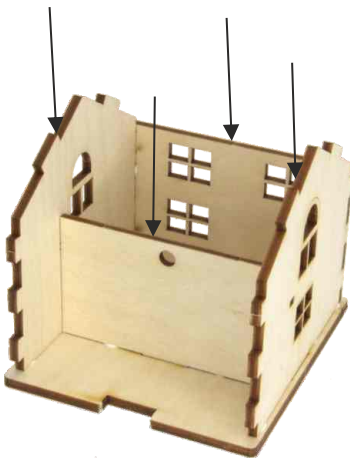
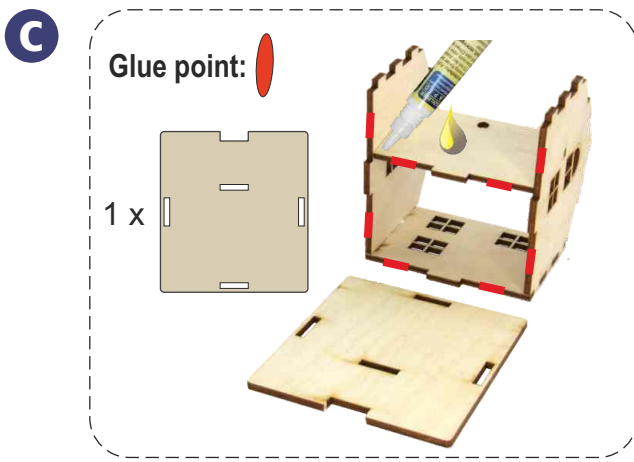
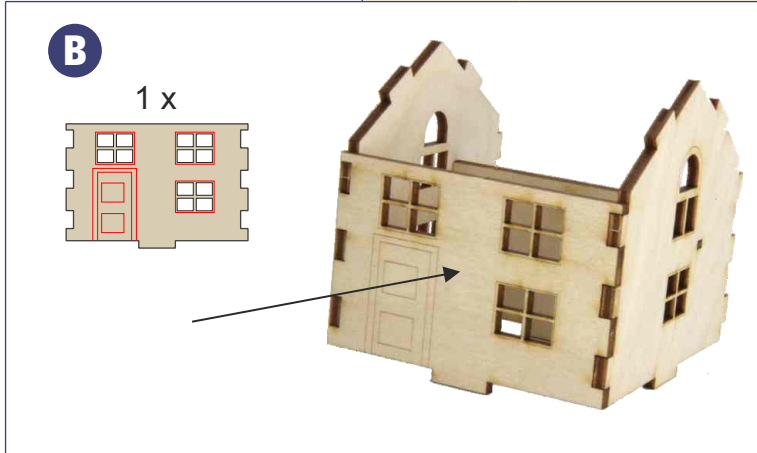
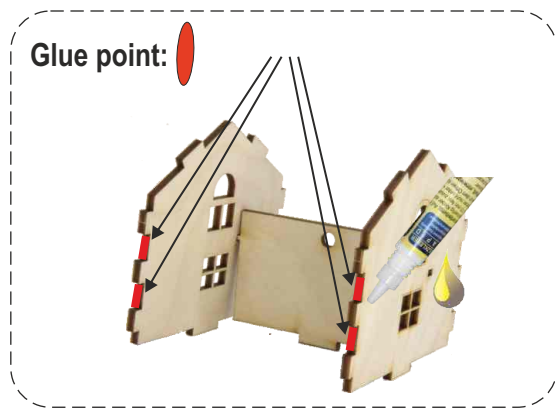
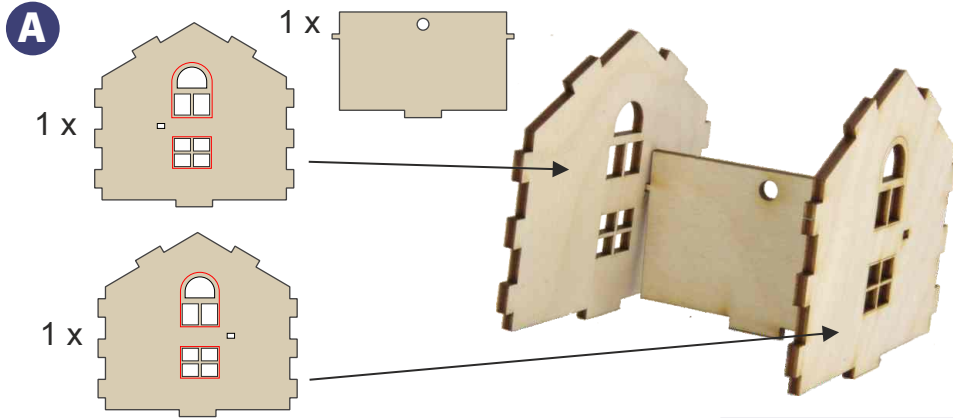

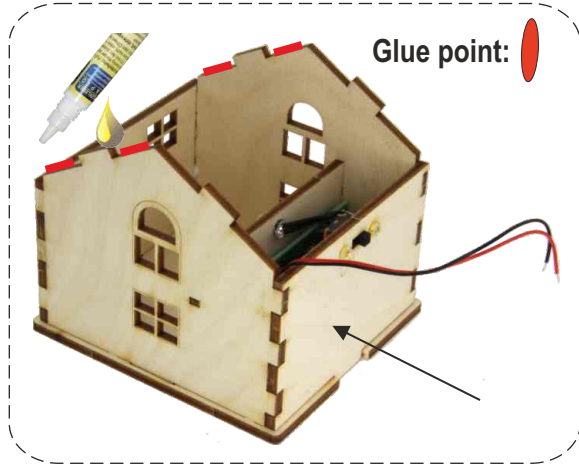
**G**

Glue point:

1 x

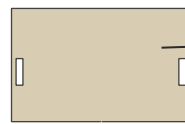

1 x

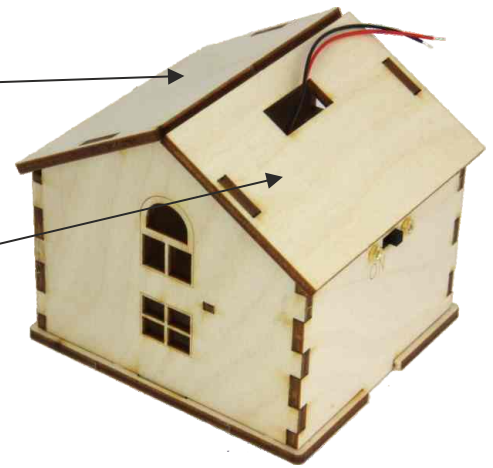
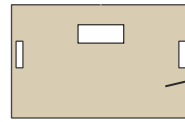
**H**

2 x

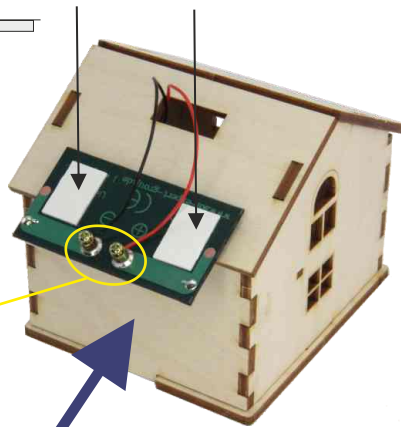
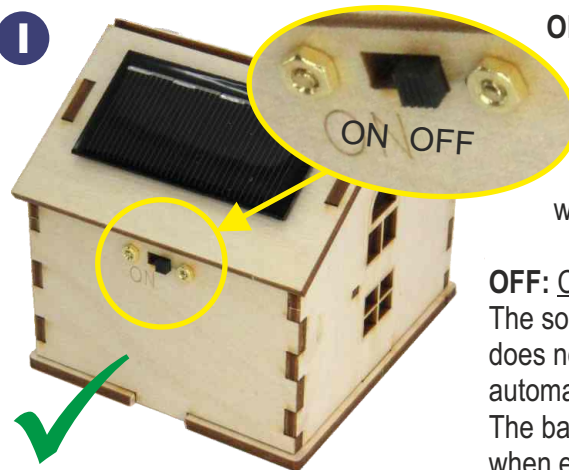
**I****ON:** Normal operation:

The solar house ECOSUN switches on automatically at dusk. The battery is charged when the sun shines

**OFF:** Charge battery only:

The solar house ECOSUN does not switch on automatically on at dusk. The battery is charged when exposed to sunlight.

### Mounting the solar panel:

A screwdriver can be used to loosen the screws of the solar module. The cable is then threaded in (red cable on ⊕) and the screws are tightened carefully with the fingers so that the cable is not sheared off.

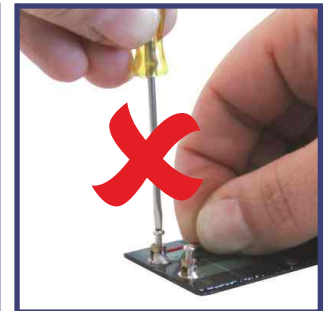
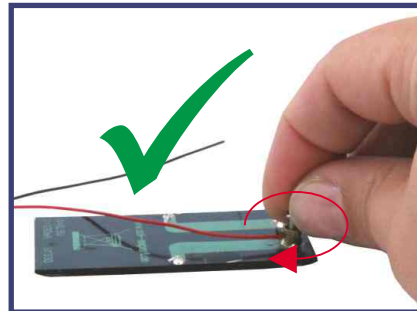

### Function:

The charging electronics in the ECOSUN solar house store energy that is collected by a solar panel in a 600 mAh Ni-MH battery. This then supplies a light-emitting diode (LED) that switches on automatically when it gets dark. When it gets light again, the LED switches off automatically. When the battery is fully charged, the LED shines all night long. The generously dimensioned solar panel with approx. 80 mA recharges the battery completely on a sunny summer day!

### This is how ECOSUN works best:

The ECOSUN solar house should be placed in a **sunny location** so that the battery can be charged by the solar panel. Make sure that the solar panel faces the sun. Places such as window ledges on the south side, covered balconies, terraces and all other sunny places are well suited. Please note that the ECOSUN solar house must not be exposed to rain, snow, etc.. ECOSUN must always be kept dry. TIP: The battery can also be charged with artificial light. Halogen lamps are particularly suitable for this. Unsuitable, however, are neon tubes and energy-saving lamps.

### Extra tip:

Before first use or if the battery is discharged due to poor light conditions, the ECOSUN solar house must be fully charged. To do this, place the model in the sun and set the switch to OFF. Now allow the charging electronics to fully charge for at least two days in the sun. After that, the model is ready for use again. The battery can be replaced. To do this, remove the roof with the solar cell, and release the switch. Now the battery is accessible and can be replaced. Then screw on the switch and mount the roof again. Battery type: 1.2 V, size AA, 600mAh, Ni-MH.